

# SAMPLE

## Support jelly for taking medicine



## Slippery jelly for taking medicine

●Name: Drinking water (jelly drink) ●Raw material: Maltose, sugar, agar, Xylitol, thickener (Pectin, Locust bean gum, Xanthane gum), Acidulant, Flavouring agent, Calcium lactate, Preservative (Sodium benzoate, benzoic acid), Food coloring (citron yellow No.5) ●Net content: 100g ●Best-by date: listed below ●Storage: Keep in a cool dry place. ●Manufacturer: listed below

Nutrition Information (Per 5g)	
Energy.....	3.00kcal
Protein.....	0.00g
Fat.....	0.00g
Carbohydrate.....	0.74g
Na.....	1.20mg
P.....	0.60mg
K.....	0.06mg
Ca.....	2.20mg

Best-by date / 20 XX.XX



Packaging material Case

JAN code

※Refer to the back side for usage

Manufacturer  **MORIMOTO-PHARMA CO., LTD.**  
 5-8-28 Mitejima, Nishi-yodogawa-ku, Osaka 555-0012, JAPAN  
 Tel.+81-6-6476-5473 Fax.+81-6-6476-5573  
<http://www.morimoto-iyaku.jp> E-mail customer@m-ph.co.jp

## <How to use>

### ■When drinking with a container

- ①Put the medicine in a container.(Small dish, teacup, tea bowl)



- ②Please massage well before opening.



- ③Please put jelly on the medicine in the container.

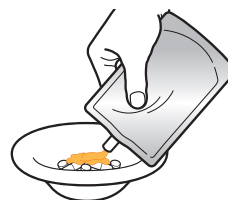

- ④Please wrap the medicine with jelly, by a spoon then drink.



### ■When drinking it with a spoon

- ①Please massage well before opening.



- ②Twist the cap and remove it.

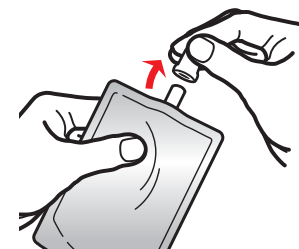

- ③Put the jelly on the spoon first, then put the medicine on it, and add more jelly to be laid over.

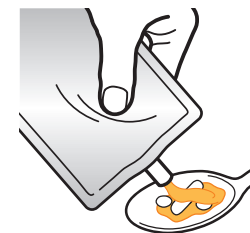

※Please adjust the amount of jelly according to the number of tablets of medicine.  
 Please adjust the amount of jelly according to the number of tablets of medicine.